

Documentation

Turbo Hybride IS38 DP-TURBO-6-VAG-600

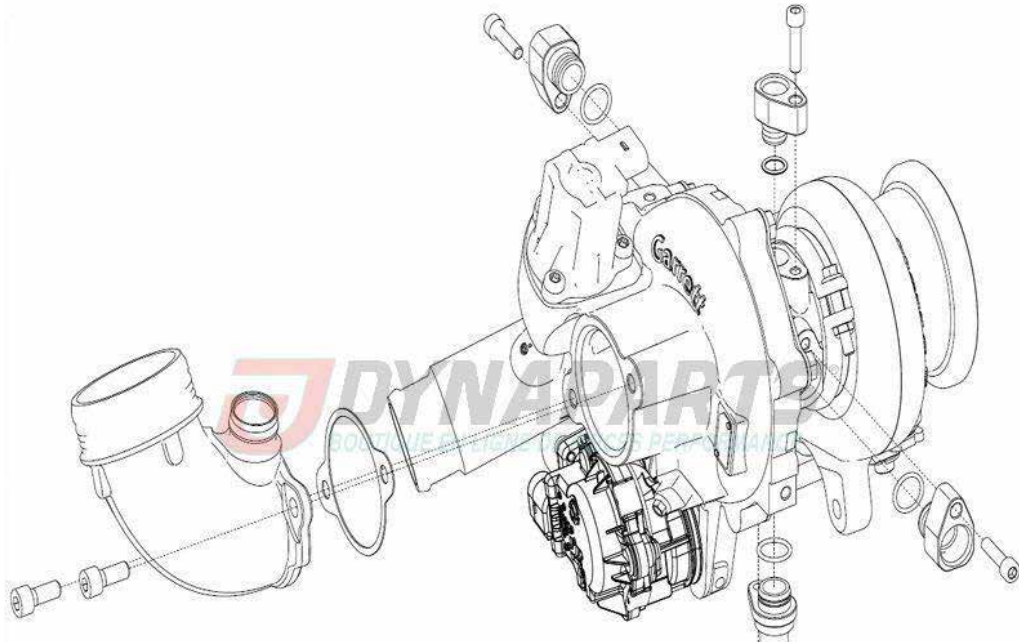

Reference	Power	Comp Ind	Comp Exd	Turb Ind	Turb Exd
DP-TURBO-6-VAG-600	600HP 447kW	54mm	67mm	54mm	49mm

Toute diffusion de ce document est interdite.

This document is in French, if you need some help to translate, please, contact us.

Stage 2 Turbocharger Reference Data:

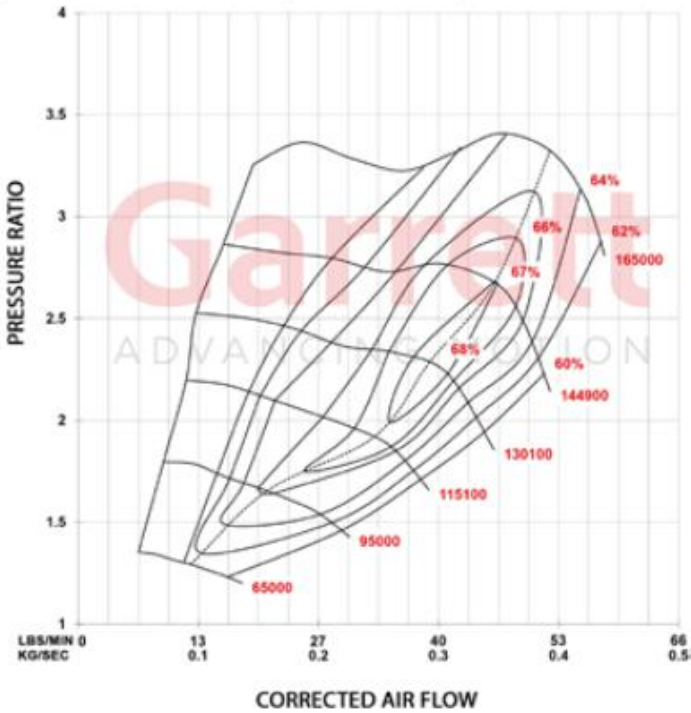

Features:

- Direct-fit stage 2 with 600 WHP | 447 kW capability*
- Complete assembly with electronic actuator
- +59% compressor flow compared to IS38 turbo (stock Golf R)
- G Series compressor and turbine wheel aerodynamics
- Mar-M alloy turbine wheel and twin scroll stainless steel turbine housing rated up to 1050° C
- Latest generation of ball bearing rotating group

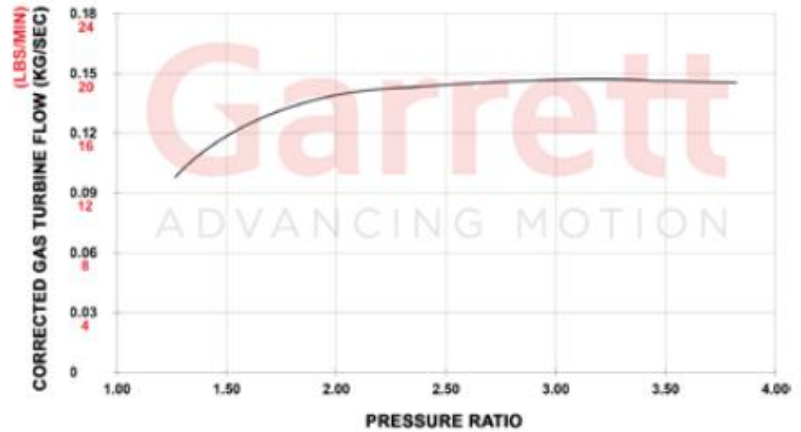

POWERMAX™ DIRECT FIT PERFORMANCE TURBOCHARGERS

On-Vehicle Power Data: Audi 2.0 TFSI (EA888 Gen 3)

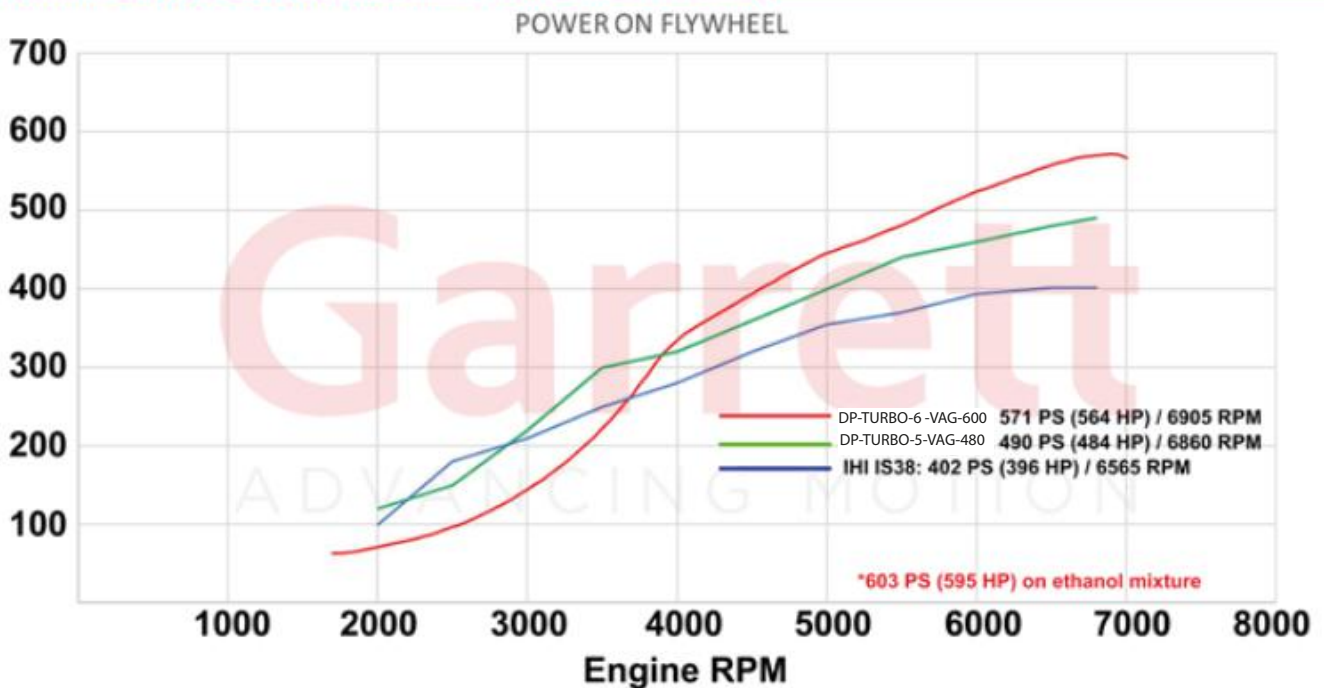

On-Vehicle Torque Data: Audi 2.0 TFSI (EA888 Gen 3)

TORQUE ON FLYWHEEL

