

Documentation

Turbo Hybride IS38 DP-TURBO-5-VAG-480

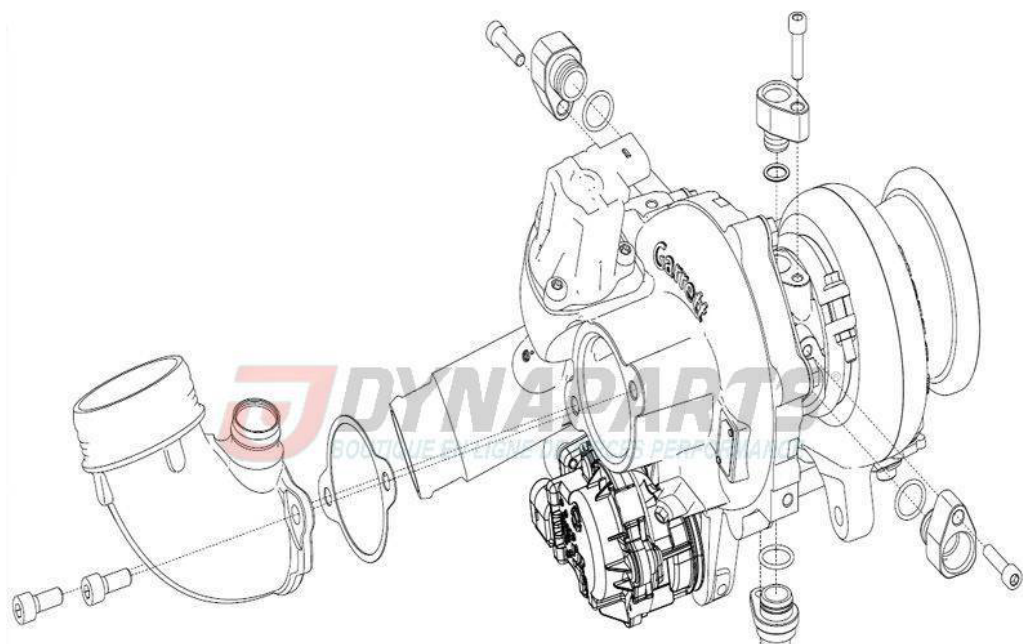

Reference	Power	Comp Ind	Comp Exd	Turb Ind	Turb Exd
DP-TURBO-5-VAG-480	485HP 362kW	47mm	60mm	50mm	45mm

POWERMAX™ DIRECT FIT PERFORMANCE TURBOCHARGERS

Stage 1 Turbocharger Reference Data:

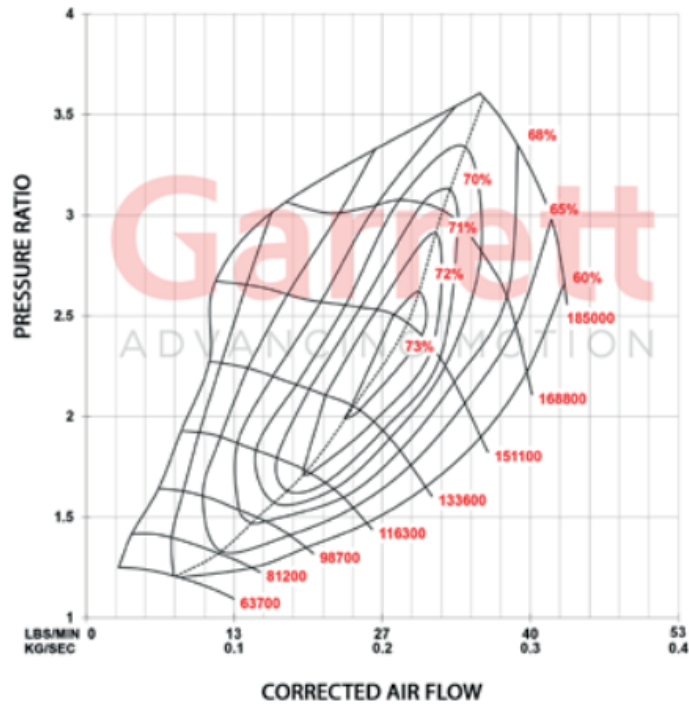

Features:

- Direct-fit stage 1 with 485 WHP | 362 kW capability*
- Complete assembly with electronic actuator
- +17% compressor flow compared to IS38 turbo (stock Golf R)
- GTX Gen II compressor aerodynamics
- Mar-M alloy turbine wheel and twin scroll stainless steel turbine housing rated up to 1050° C
- Latest generation of journal bearing rotating group with 360° reinforced thrust bearing

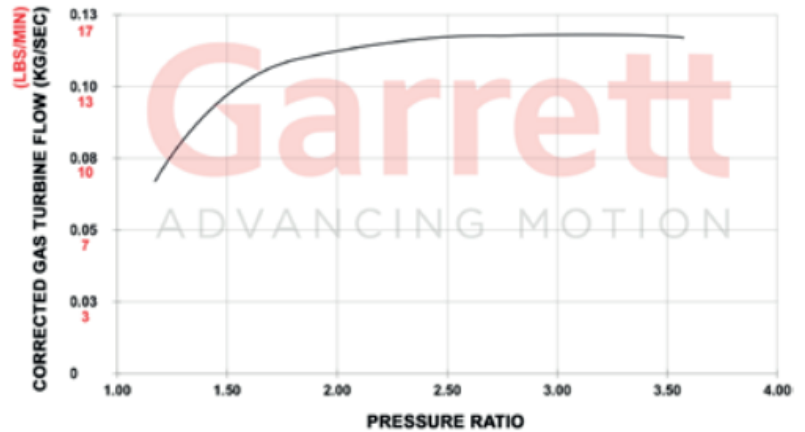

POWERMAX™ DIRECT FIT PERFORMANCE TURBOCHARGERS

On-Vehicle Power Data: Audi 2.0 TFSI (EA888 Gen 3)

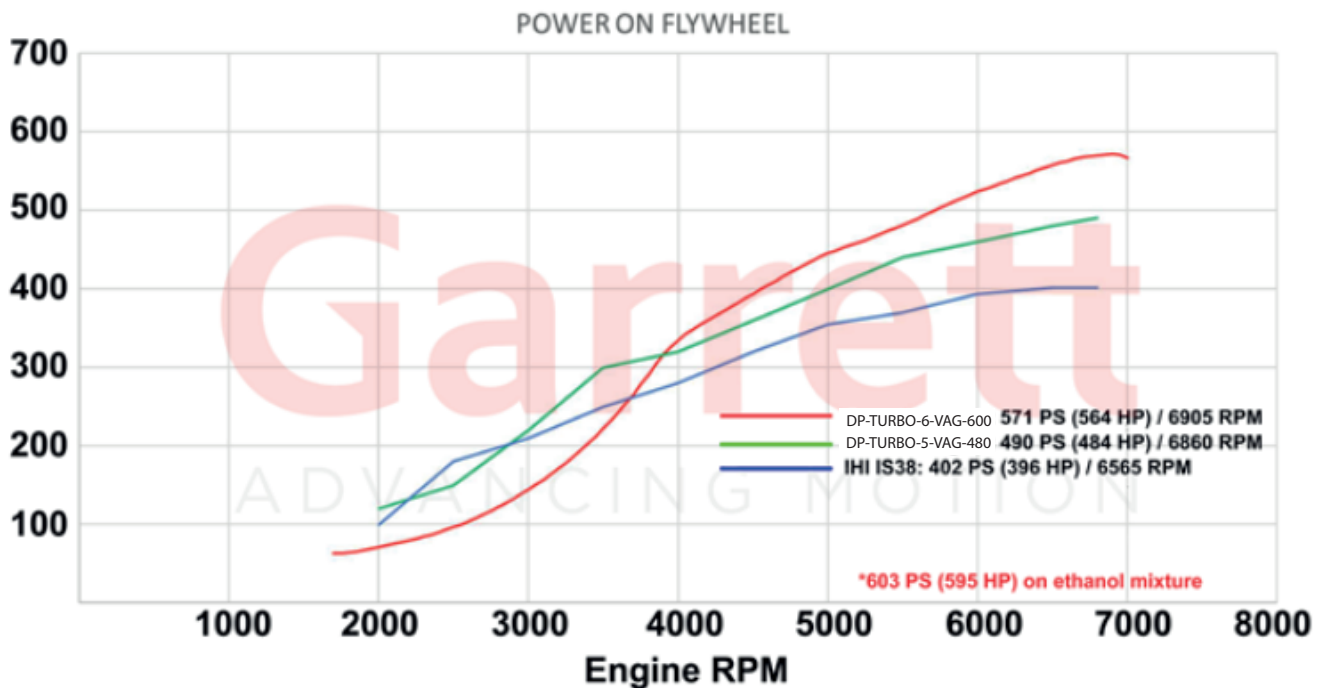

On-Vehicle Torque Data: Audi 2.0 TFSI (EA888 Gen 3)

